

**Powder will not build up!**

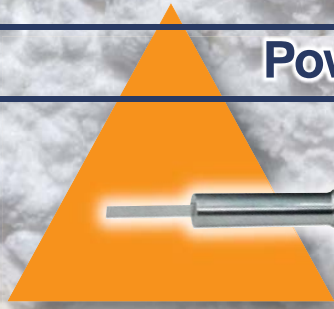

KVX/XV2 SERIES

**Angled rod**



I'm having trouble in measuring the materials in this tank.  
The output doesn't turn OFF. Can you please check it out?

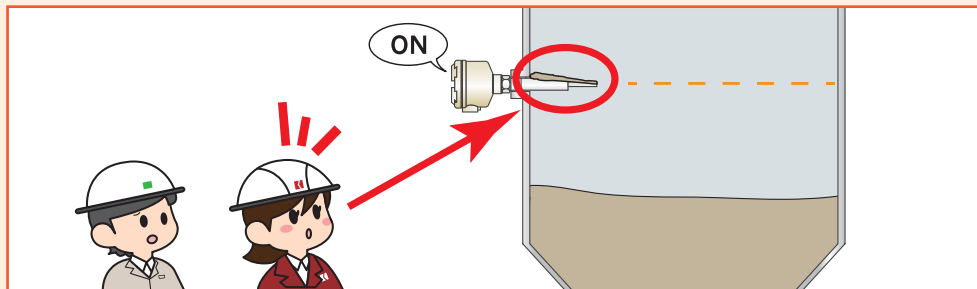

I see the material remains on the vibrating rod. That causes the output ON.  
Let's replace the current rod with the optional angled rod.  
The rod is angled so that the materials doesn't build up on it!

### Image of the vibrating rod

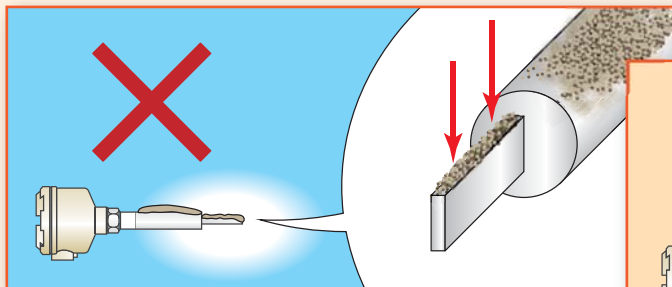

### Image of the vibrating rod

If the sensitivity is high, the output will not turn off when the material remains on the rod.

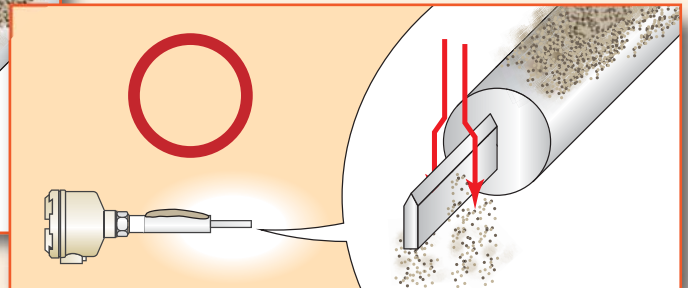

### Standard vibrating rod

Because the rod is angled, the material will be sliding off the rod, then the output turns off.



I see! The powder is falling off the rod. It will definitely help to measure correctly!

### Applicable models

**KVX series (Compact)**

Process connection R1

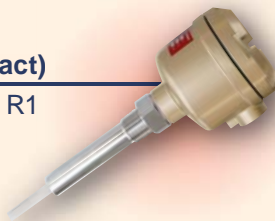

**XV2 series (Super compact)**

Process connection R3/4

