

# Capacitance level switch

- Wire probe type -



Easy to use!

Special specs available!

Among so many variations of capacitance level switch, we will introduce "Wire probe type".

## 01 Product feature

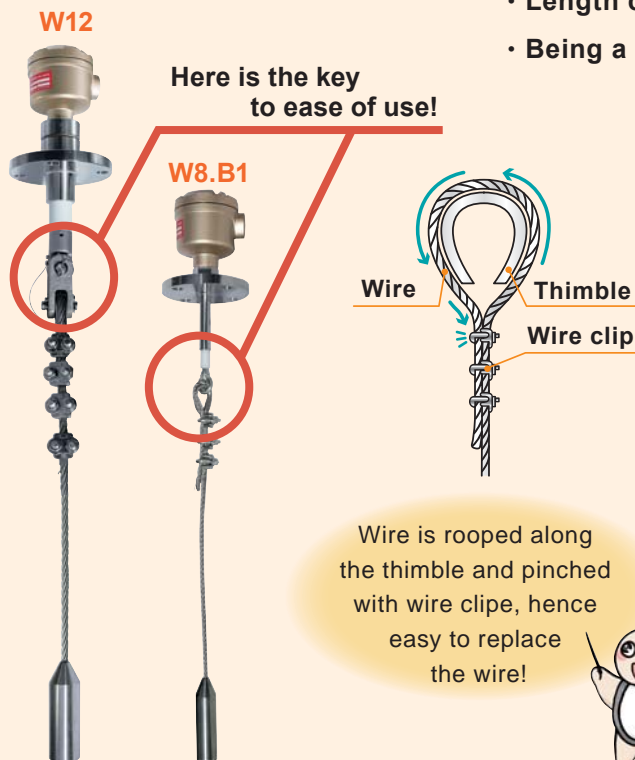

Wire is rooped along the thimble and pinched with wire clipe, hence easy to replace the wire!



- Easy to handle the long probe
- Length can be changed at the site
- Being a wire probe, easy to replace it when necessary

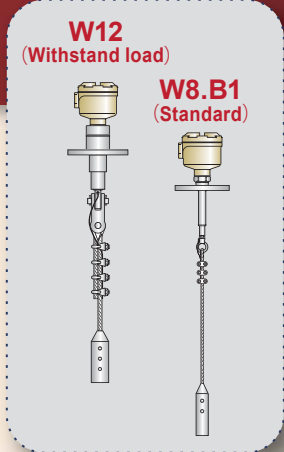

## 02 Application

- Cement industry
- Power plant
- Iron, steel, metal
- Food
- Glass

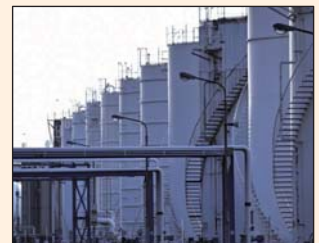

## 03 Special specs — Examples —

### ① Smaller process connection (W8.B101)

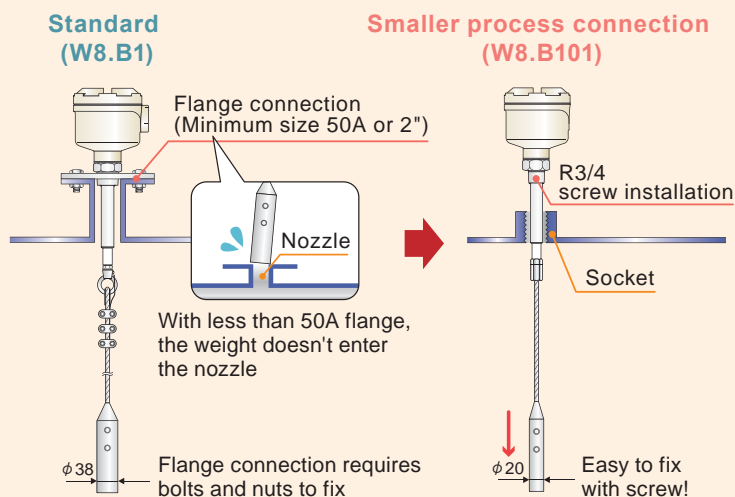

### ② Chain weight ~ When measuring solid lump ~

